

Technical data sheet



Product features

Tilting bratt pan gas s nerezová " m dnem

Model	SAP Code	00012288
--------------	-----------------	----------



- Bottom material: Stainless steel - suitable for cooking, easy maintenance
- Bottom thickness: 12.00
- Basin volume [l]: 120
- Usable volume [l]: 120
- Ignition: Piezo
- Tilting: Manual with auxiliary spring
- Filling: Mechanical cock
- Type of pan: Tilting
- Basin shape: Practically shaped bathtub spout to minimize spillage
- Protection of controls: IPX4

SAP Code	00012288	Type of gas	Natural gas, propane butane
Net Width [mm]	1200	Bottom material	Stainless steel - suitable for cooking, easy maintenance
Net Depth [mm]	900	Basin volume [l]	120
Net Height [mm]	900	Usable volume [l]	120
Net Weight [kg]	184.00	Tilting	Manual with auxiliary spring
Power gas [kW]	30.000		

Technical data sheet



Technical drawing

Tilting bratt pan gas s nerezovǎ " m dnem

Model

SAP Code

00012288

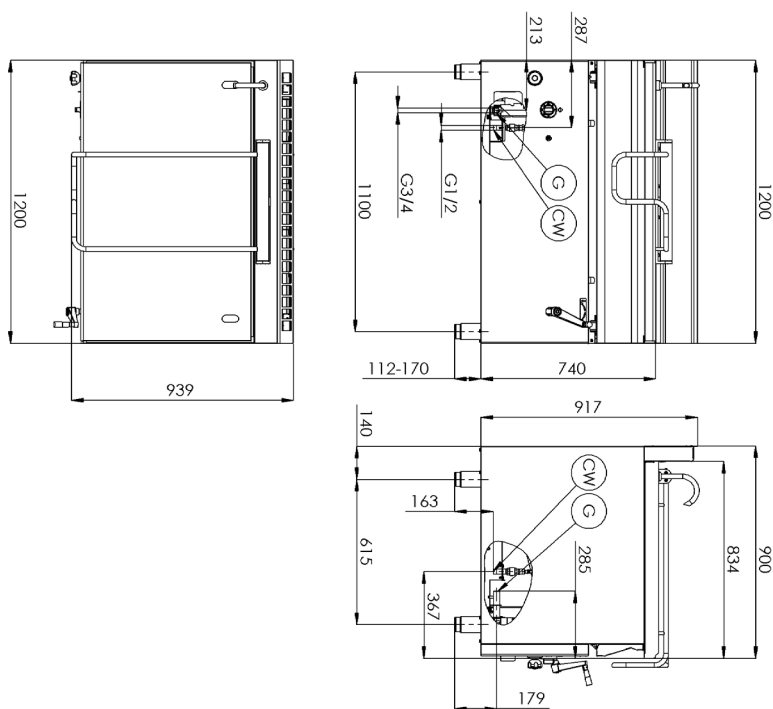

Technical data sheet



Technical parameters

Tilting bratt pan gas s nerezová " m dnem

Model

SAP Code

00012288

1. SAP Code:

00012288

2. Net Width [mm]:

1200

3. Net Depth [mm]:

900

4. Net Height [mm]:

900

5. Net Weight [kg]:

184.00

6. Gross Width [mm]:

970

7. Gross depth [mm]:

1240

8. Gross Height [mm]:

1170

9. Gross Weight [kg]:

203.00

10. Device type:

Gas unit

11. Construction type of device:

Stationary

12. Power gas [kW]:

30.000

13. Ignition:

Piezo

14. Type of gas:

Natural gas, propane butane

15. Protection of controls:

IPX4

16. Device color:

Stainless steel

17. Material:

AISI 304 top plate, AISI 430 cladding

18. Basin volume [l]:

120

19. Device capacity [l]:

120.00

20. Safety thermocouple:

Yes

21. Tilting:

Manual with auxiliary spring

22. Bottom thickness:

12.00

23. Bottom material:

Stainless steel - suitable for cooking, easy maintenance

24. Type of pan:

Tilting

25. Usable volume [l]:

120

26. Filling:

Mechanical cock

27. Basin shape:

Practically shaped bathtub spout to minimize spillage